

TECHNICAL DATASHEET

Wireless Vibration Sensor - Wi-care 130 G23



PRODUCT FEATURES

Vibration measuring range [g]	+/- 40g
Vibration measurement range [mm/s]	from 31200mm/s @2Hz to 6.2 mm/s @10kHz
Frequency range [Hz]	2Hz to 160kHz
Number of measurement axes	3
Temperature measurement	Yes
Temperature measurement range	-40°C to +125°C
Standard measurement cycle	4 measurements per day
Sensor type or technology	Piezo : X, Y, Z
Minimal period between measurements	15 minutes
Protection class	IP67
Spectrum resolution	Up to 16000 lines

ELECTRICAL DATA

Power supply	Battery Lithium Thionyl Chloride 3,6V 8,5 Ah
Battery life	5 years based on default operation

ACCURACY / DRIFT

Sensitivity (mV/g)	25 mV/g
Sensitivity tolerance	+/- 15%
Freq. range (+/- 3dB)	2Hz to 10kHz
Amplitude Linearity (%FSO)	+/- 1%

SOFTWARE/PROGRAMMING

Interface for display data	I-see
Alert via SMS, EMAIL	Yes
External software compatible	Yes
Parameterisation options	Yes

COMMUNICATION

External software compatible	Yes
Parameterisation options	Yes

OPERATING CONDITIONS

Ambient temperature [°C]	-10°C to +85°C
--------------------------	----------------

MECHANICAL DATA

Weight [g]	190g
Mounting type	Glue stud, M6 stud, M8 stud

Ex CERTIFICATIONS

Certifications	IS Class 1, Div. 1, Group ABCD Ex ia IIC T4 Ga Class 1, Zone 0, ATEX ia IIC T4 Ga
----------------	-----------------------------------------------------------------------------------------

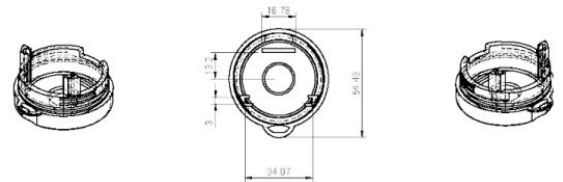

FREQUENCY RESPONSE

